



FLINT & WALLING

Zoeller Family of Water Solutions™

LAWN SPRINKLER PUMPS



SPJ Self-Priming

- High capacity, high volume
- Cast iron pump body and mounting ring for long life
- Flint & Walling's Service Plus NEMA J, capacitor start, double ball bearing motors for continuous operation
- Easy access drain plug
Designed for lawn sprinkling, irrigation and more
- Rapid self-priming characteristics under maximum suction conditions



SPJ SERIES
3/4 - 3 HP
Single or Three Phase

SPM Series

- High capacity, high pressure
- Large cast iron pump body ensures rapid priming
- JM frame industrial duty motor
- Self-adjusting, water-lubricated mechanical seal for maintenance free operation
- Designed for lawn and turf sprinkling, irrigation and water transfer
- Cast iron impeller for long life
- Built-in check valve facilitates priming and prevents backflow



SPM SERIES High Head
3 and 5 HP
Single or Three Phase

SPJ SELF-PRIMING 3/4 - 3 HP SINGLE OR THREE PHASE

SPJ SERIES PERFORMANCE

SPECIFICATIONS

Model Number 1 Phase 3 Phase	HP	Suction Lift Ft.	Discharge Pressure PSI												Shut-Off Pressure PSI	Suction Pipe Tap	Disch. Pipe Tap
			10	15	20	25	30	35	40	45							
SPJ07P1 SPJ07P3	3/4	15	47	42	37	29	22	10	21	12					41	2"	1-1/2"
SPJ10P1 SPJ10P3	1	15	58	53	48	43	38	32	32	24	11				48	2"	1-1/2"
SPJ15P1 SPJ15B3	1-1/2	15	78	77	74	70	62	53	43	30	30	47			47	2"	1-1/2"
SPJ20B1 SPJ20B3	2	15	86	84	81	77	71	62	52	40	40	50			50	2"	1-1/2"
SPJ30B1 SPJ30B3	3	15	88	86	85	84	80	73	64	54	54	64			64	2"	1-1/2"

Motor voltage: Single Phase 3/4 - 2 HP - 115/230V; 3 HP - 230V, 60Hz
Three Phase 3/4 - 2 HP - 208 - 230/460V, 50/60Hz; 3 HP - 208 - 230/460V, 60Hz
Maximum Case Pressure: 100 PSI

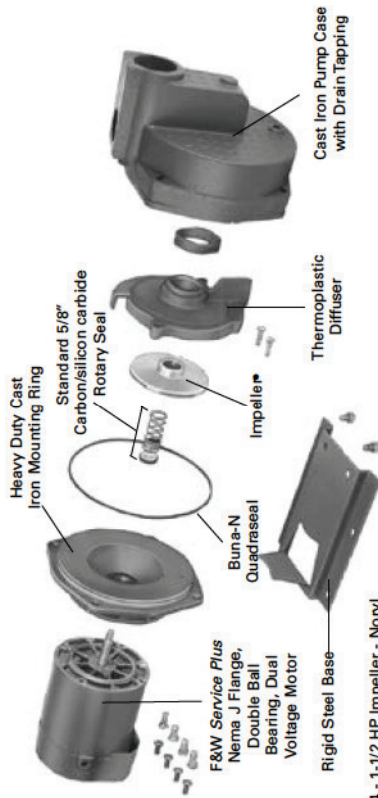

- 3/4 - 1-1/2 HP Impeller - Noryl
1-1/2 - 3 HP Impeller - Brass



SPM SERIES HIGH HEAD 3 HP and 5 HP, Single or 3 Phase

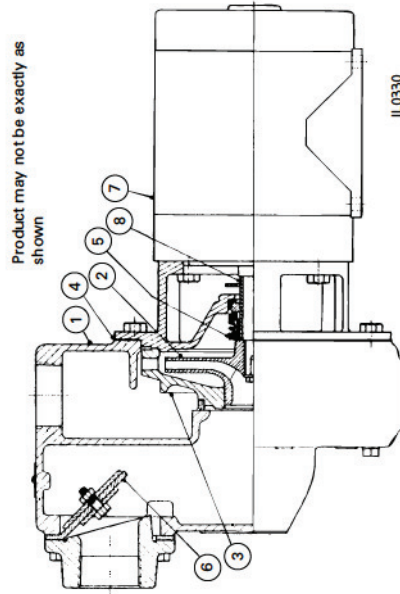

1. Housing - Cast iron ASTM 48 class 30
2. Impeller - Cast iron ASTM 48 Class 20, closed type, 6 vane
3. Diffuser - Cast iron ASTM 48 Class 20, 7 vane
4. Gasket - Red rubber
5. Seal - 1-1/4" Type 21 mechanical seal
6. Valve Gasket - Neoprene rubber, nylon fabric reinforced
7. Electric motor - JM Frame, industrial duty
8. Sleeve - Replaceable shaft sleeve, stainless steel type 304

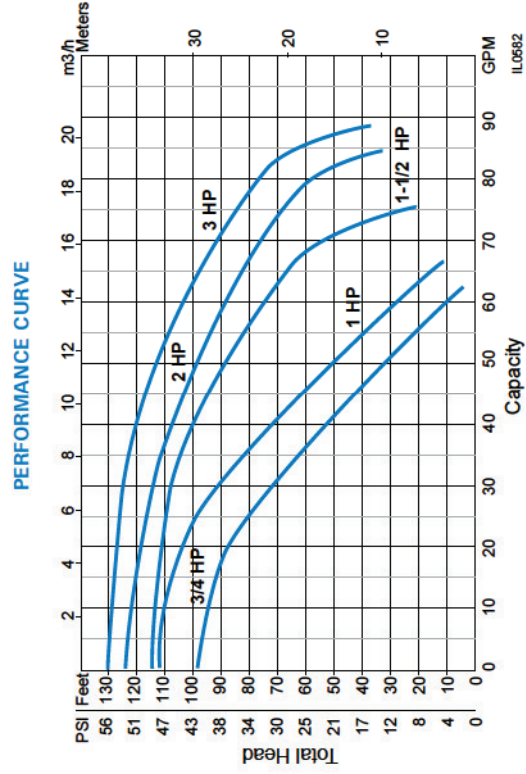

SPM SERIES PERFORMANCE



FLINT & WALLING

Zoeller Family of Water Solutions™

PERFORMANCE SPECIFICATIONS

MODEL NUMBER		HP	SUCTION LIFT FT.	DISCHARGE PRESSURE -PSI						SHUT-OFF PRESSURE PSI	SUCTION PORT NPT.	DISCHARGE PORT NPT.
1 PH.	3 PH.			10	20	30	40	50	60			
CAPACITY-U.S. GALLONS PER MINUTE												
SPM30A1	SPM30A3	3	5	120	118	91	72	47		57.3	2"	2"
			10	103	100	88	68	40		55.2		
			15	91	90	83	66	31		53.0		
			20	76	75	74	59	19		50.8		
			25	54	54	54	49			48.7		
SPM50A1	SPM50A3	5	5		158	141	123	104	81	72.5	2 1/2"	2"
			10		138	127	115	99	67	70.3		
			15		124	117	107	92	64	68.2		
			20		104	102	96	82	48	66.0		

Motor Voltage: Single Phase: 3 HP, 115/230V 60Hz; 5 HP 230V, 60Hz Three Phase; 3-5 HP, 208-230/460, 60Hz

Maximum Case Pressure: 125 PSI



MODEL SPM30A1, 3 HP, 1 PH
MODEL SPM30A3, 3 HP, 3 PH

MODEL SPM50A1, 5 HP, 1 PH
MODEL SPM50A3, 5 HP, 3 PH

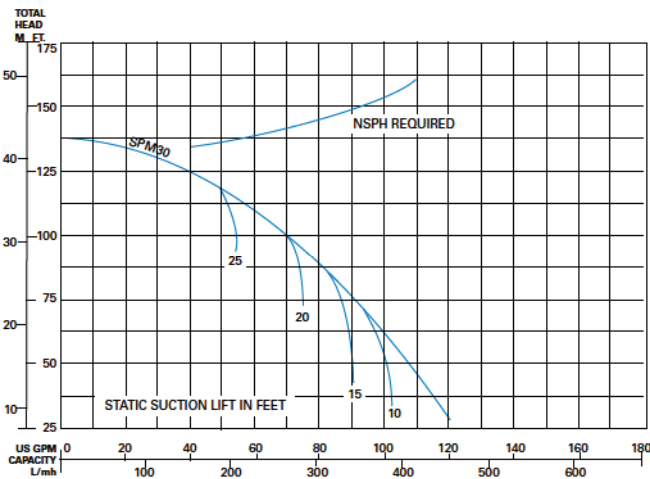

IL0353

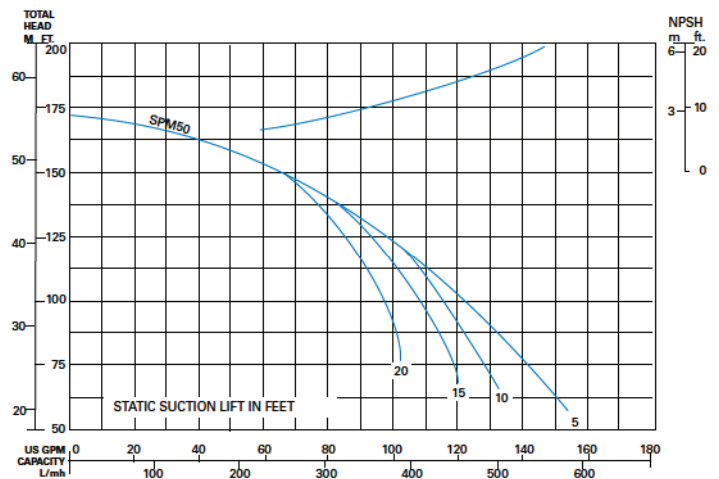

IL0354

MESA AGRO-INDUSTRIAL CORP.
 BOMBAS DE AGUA --FILTROS --COMPRESORES DE AIRE --GENERADORES DE ELECTRICIDAD
 TRACTORES E IMPLEMENTOS AGRICOLAS --PISTEROS Y SISTEMAS DE RIEGO --MANGAS --VALVULAS
 TELS. 939-338-0607 --787-636-2132 - FAX. 787-740-0960
 E-mail: mesaagro@hotmail.com - www.mesapr.com